

# IRTS | Innovative Rotary Table Solutions

## Series B1-HV & B1-V

One Axis Rotary Table (Horizontal / Vertical Convertible)

One Axis Rotary Table (Machining on Vertical Axis Only)

Size Range 500mm thru 800mm

(20 inch rotary table thru 31 inch rotary table)

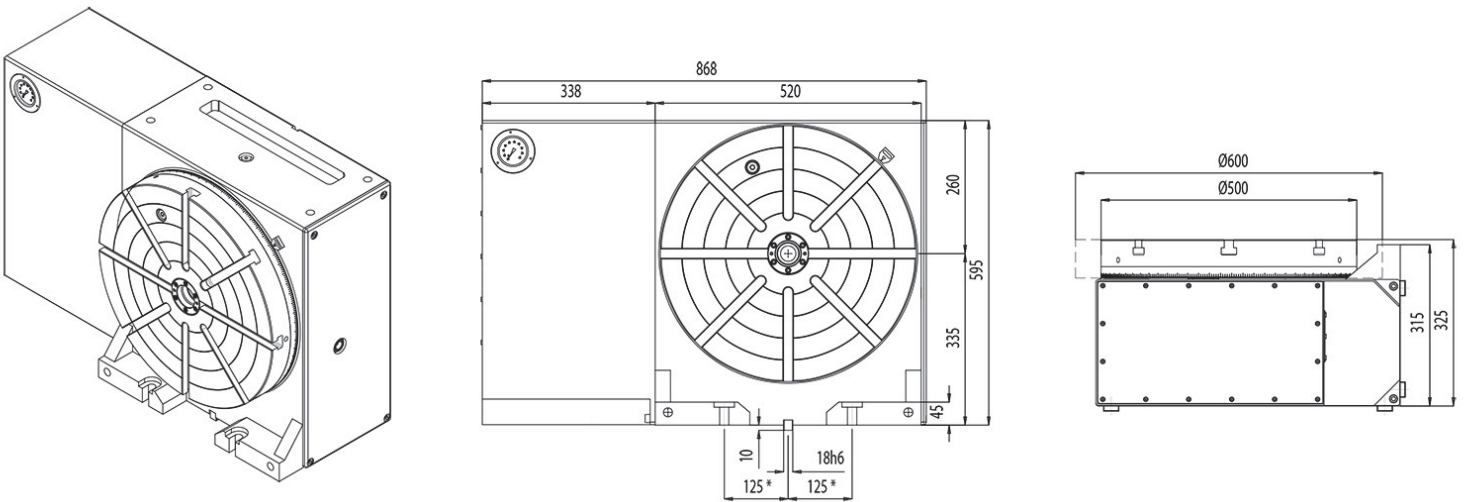

### Specifications

- Horizontal/Vertical Axis Working Conditions
- Compact and Flexible Design Casting Body
- Robust and Rigid Body Allowing Heavy Machining
- Improved Brake System Avoiding Distortions and Improving Machining Conditions
- Powerful Pneumatic Clamping Torque
- High Accuracy

### Options

- Available with All Types of Motors
- Flexible Motor Positioning (Right, Left)
- Rotary Encoder can be Fitted to Further Increase Accuracy
- Available Through Bore Option

## Accessories

- Tailstock (Manual, Pneumatic, Hydraulic)
- Tail Spindle
- Trunnion
- Rotary Joint
- Face Plate
- Scroll Chuck with Jaws
- Steady Rest
- Rotary Support

## TECHNICAL DESCRIPTION

		B1-D500-HV	B1-D600-HV	B1-D800-V
Face plate diameter	mm	Ø500	Ø600 <sup>s</sup>	Ø800
Face plate "T" slot width	mm	(1) 18H7 - Rest. 18H10		
Type of slots	-	Radial		
Distance between slots	-	To determine by customer		
Plate height (horizontal position)	mm	325	325	346
Center height	mm	335	335	-
Center bore nose diameter	mm	Ø50H7x30	Ø50H7x30	Ø80H7x30
Guide block width	mm	18h6 (opt.22h6)		
Clamping distance to table	mm	125/200 <sup>s</sup>		
Standard configuration	-	Horizontal / Vertical axis		Vertical axis
Motor position	-	Right (optional left)		
Indexing accuracy - direct encoder	arc sec	RCN2380/90F ± 5" (R.Table ±7") / RCN2580/90F ±2,5" (R. Table ±5")		
Indexing accuracy - direct encoder	arc sec	RCN8380/90F ± 2" (R.Table ±4") / RCN8580/90F ±1" (R.Table ±3")		
Repeatability	arc sec	±1"		
Main bearing diameter	mm	260x385x55		
Clamping system	-	Hydraulic		
Clamping torque	Nm	2.500	2.500	2.500
Clamping pressure	Bar	40	40	40
Work load - Plate horizontal	Kg <sup>1</sup>	1.500	1.500	1.500
Work load - plate vertical		750	750	-
Work load - plate vertical W/TS		1.500	1.500	-

Maximum axial force - Horizontal	N <sup>3</sup>	40.000	40.000	40.000
Maximum axial force - Vertical	N <sup>3</sup>	30.000	30.000	-
Tilting moment - Horizontal	Nm <sup>3</sup>	8.000	8.000	8.000
Tilting moment - Vertical	Nm <sup>3</sup>	5.000	5.000	-
Transmissible torque maximum speed	Nm	2.675	2.675	2.675
Recommended motor torque	Nm	27	27	27
Motor speed	rpm	2000/3000		
Table rotation speed	rpm <sup>4</sup>	11,11 / 16,66	11,11 / 16,66	11,11 / 16,66
Gear and pinion reduction	i	90/1	90/1	90/1
Belt / Pulley	i	2/1 (opt.3/1)	2/1 (opt.3/1)	2/1 (opt.3/1)
Total reduction ratio	i <sup>2</sup>	180/1 (opt.270/1)	180/1 (opt.270/1)	180/1 (opt.270/1)
Flatness of plate turning	mm	0,020	0,020	0,020
Perpendicularity	mm	0,020	0,020	0,020
Concentricity center bore	mm	0,010	0,010	0,010
Net weight (W/O Motor)	Kg	450	630	800
Equipped with digital servo motor	SIEMENS	1FK7 101-2AF71-1AG0		
	HEIDENHAIN	QSY 155D EcoDyn		
	FAGOR	FKM 83.30A		
	FANUC	ALPHA ais22/4000HV		
Moment of inertia (approx.)	Kg.m <sup>2</sup>	180	200	215
Lubrication oil CEPSA EP-80W90				

## USA Sales, Service & Repair Contact

Rusach International

100 Raymond Street Hope, IN, USA 47246

317-638-0298 [www.rusach.com](http://www.rusach.com) [sales@rusach.com](mailto:sales@rusach.com)

